

New CDPL Databases plus Local History Collections Digitized

Added since 2017

Presented by **Dellie J Craig** -- CDPL Local History Specialist
President of the Genealogy Club of Montgomery County IN Corp
21 December 2019 at Dorothy Q Chapter house in Crawfordsville, Indiana

Marian Morrison Local History Collection



LOCAL HISTORY AREA -- Starting place



ARCHIVES AND DIGITIZING AREA

Marian Morrison Local History Collection

COMPUTERS FOR GENEALOGY USE ONLY



RESEARCH TABLE AREA

Marian Morrison Local History Collection

RG (Local History General)

RA (Local Author)

RL (Montgomery County)



MICROFILMS AND READERS

One machine just goes to print

Other two machines connect to computers
(can print and save to flashdrive)



Changed in 2018 from “DB textworks to Presto”

Search All Databases



Using the above feature you will see the first 5 listings in each category. But there is an additional button to show full list

Use the links below you have option to choose individual databases to search.

Events, Cemeteries, Bibles, Genealogy Vertical File, Guardian, Local History Collection, Images Montgomery County Magazine, Marriage, Naturalizations, Persons & Firm, Scores (music), Teachers, Veterans, Vitals, and Yearbooks

After 15 years, and our CDPL databases growing, Bill Helling and Angela White decided to finally upgrade to Presto for more thorough searching .

This made for several changes and patrons weren't too happy with it at first. **Change takes time!!!**

Patrons learned how to do searches on individual databases. Then, they found they could better search by using “Search All Databases.” They now are enjoying having best of both worlds.

New Richmond Collection

donated by family of Phyllis Way Boone's family



Author Phyllis Way Boone

This book was later published by the Boone family in 2016 in memory of Phyllis Way Boone. This research was compiled over many years and now this very special collection is housed in the Marian Morrison LH Collection at CDPL.

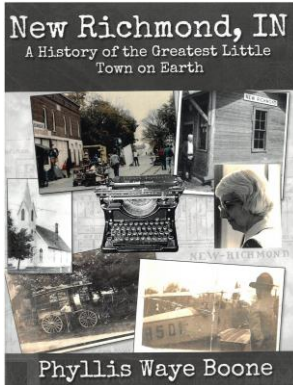

Stephanie Cain, *pictured at right*, granddaughter of local author Phyllis Way Boone, and her mother, Janice Boone Cain, *pictured at left*, delivering the special newspaper 'motherload' at Crawfordsville District Public Library.

Photos of New Richmond donations

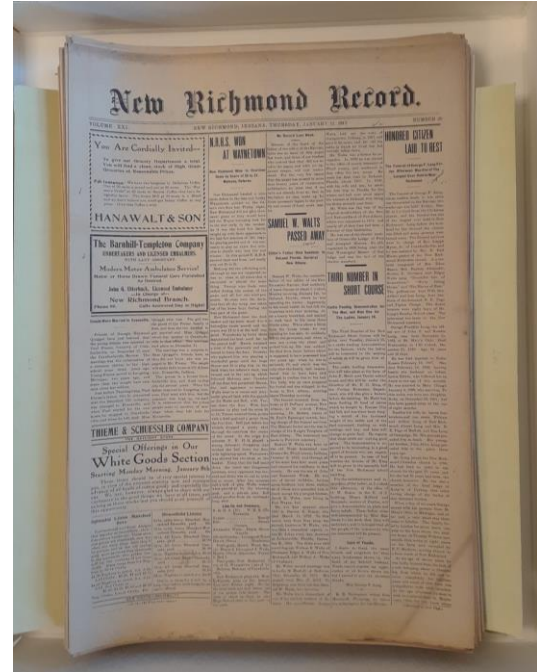
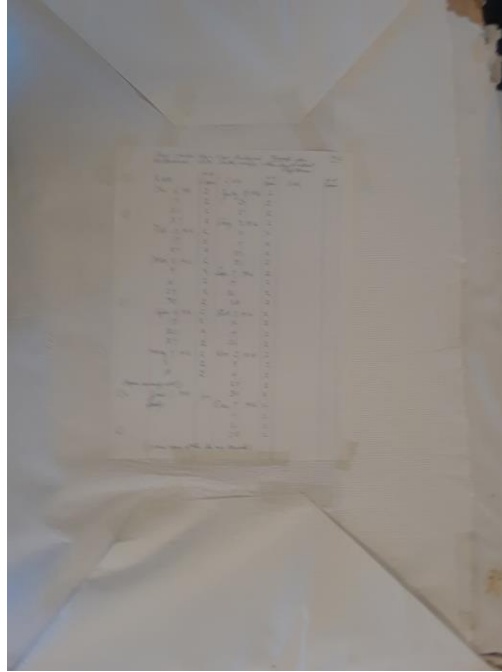
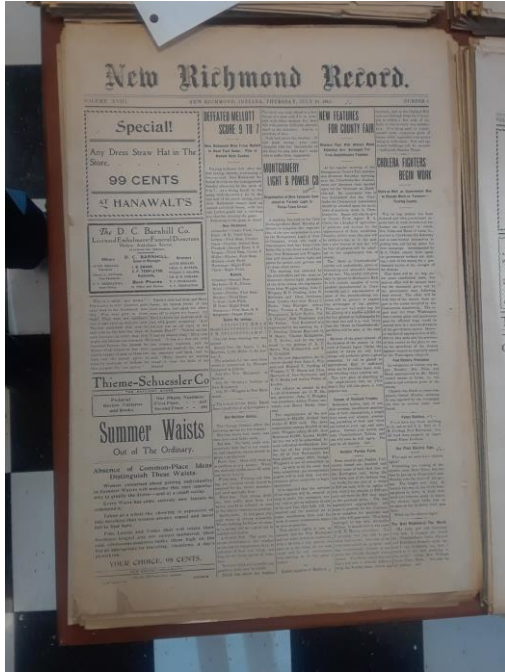

New Richmond donation in-processing



“The Newspaper Mother Load”

The Farmer’s Review

Record

New Richmond



New Richmond donation turned to microfilm

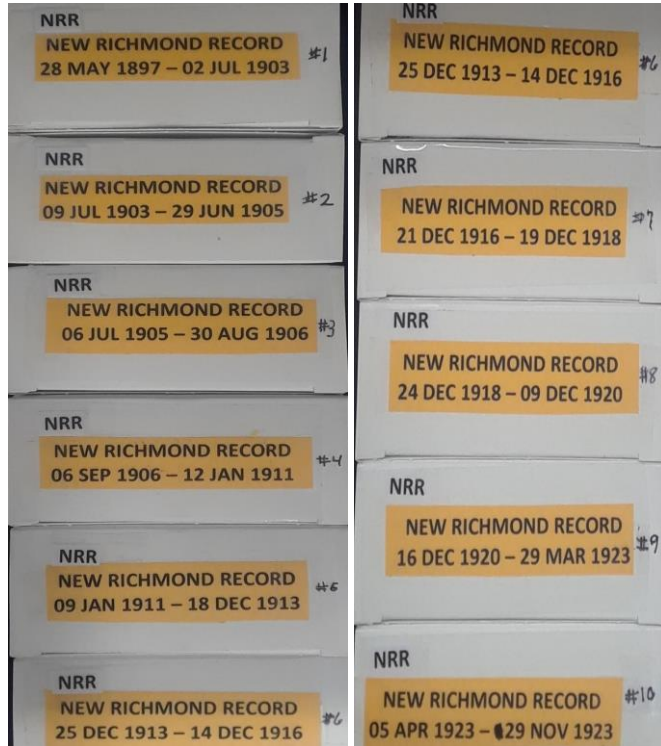

Other parts of New Richmond Collection



- NR BUSINESS FILES
- NR CHURCH FILES
- NR FAMILY CLIPPING FILES
- NR FAMILY FILES
- NR MISCELLANEOUS FILES
- NR TOWN FILES



NOT ON LH DATABASE AT THIS TIME.

Marriage Collection: (affadavit, consent, licenses, records)

<http://history.cdpl.lib.in.us/Presto/content/AdvancedSearch.aspx?ctID=ZjYwNGI3M2MtMzkwNC00YjYxLThkYjktNjhhNzE5OGIzMjli>.

At this time they have 2029 of these supplemental documents on above site alot more to come.

The pdf can be downloaded to your computer.

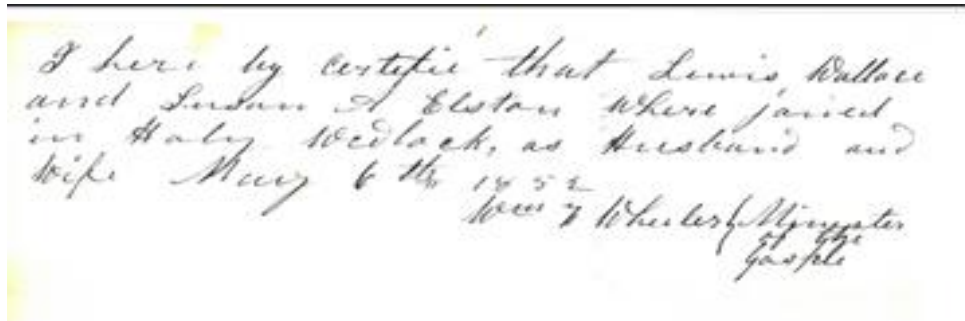

I here by certifie that Lewis Wallace
and Susan A. Elston were joined
in Holy Matrimony, as husband and
wife May 6th 1852
Wm. J. Wheeler Minister
of the Gospel

Supplemental

Accession number : 20180613-1463

CDPL Local History/Genealogy digitized resources

- **Audio and video interviews** of local citizens and veterans.
- **Montgomery County Township surveys** (Surveyor's Records) – Original Section Corner Survey Records, 14 books, covering 1832-1977.
- **Montgomery County Township plat maps** – Original plat maps, covering 1875-1932.
- **Register of Negroes and Mulattoes:** Images (.pdf) of the actual pages, covering 1851-1853.
- **Sanborn map of Crawfordsville, 1925:** Single image of the February 1925 Sanborn insurance of Crawfordsville, Indiana. Separate detailed sections of the map are available onsite.
- **Coal Creek Central Alumni Minutes 1955-2000** (.pdf)
- **Coal Creek Farmer Association ledger 1919-1924** (.pdf)
- **Clerk Records (1868-1874):** Records of city proceedings, minutes, reports, bylaws, etc.
 - Mayor John Speed (1868-1870) (.pdf) 44MB
 - Mayor William Elston (1870-1872) (.pdf) 23MB
 - Mayor Wilson Laymon (1872-1873) (.pdf) 26MB
 - Mayor John Coons (1873-1874) (.pdf) 14MB
- **Atlas of Montgomery County:** 1878 Images of the complete atlas (.pdf) Illustrated Historical Atlas of the State of Indiana (1876) Leads to maps of not just Indiana counties and towns, but also to national maps and statistics from the 1870 United States Census.
 - <http://www.cdpl.lib.in.us/services/local-history-and-genealogy>

<http://www.cdpl.lib.in.us/services/reference/montgomery-county-township-surveys>

Section Corner Survey records

The **Montgomery County Surveyor's Office** donated county survey records for digitization. These books give section, township, NR, and direction. The books help locate corners, size, marks, witness size, direction, distance, and marks. Some have updated surveying notes through the years due to request of heirs or representative. Read more about **section corner perpetuation** on the Surveyor's website.



Survey Reports --field notes

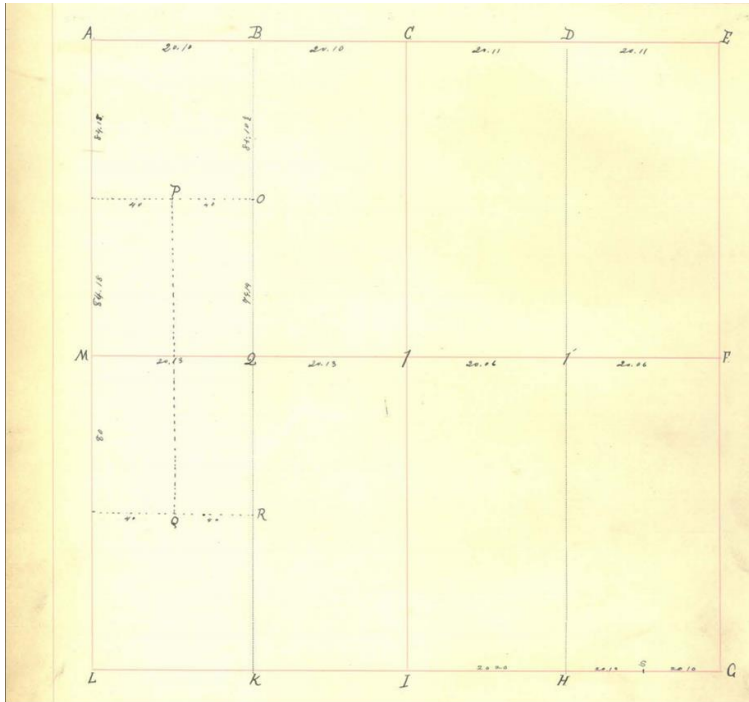

INDEX	CORNERS	SIZE	MARKS	WITNESSES	SIZE	DIRECTION	DISTANCE	MARKS
A								
B				Chalk	20	S 72° E	34	
C				Chalk	20	N 33° W	38	
D				S. Boundary	16	S 77° W	12	
E				Chalk	14	N 20° E	14	
F				Chalk	14	S 72° E	34	
G				Chalk	14	S 21° W	24	
H	Stone							
I	Stone							
J	Stone							
K				Chalk	8	S 92° E	8	
L	Stone			History	20	S 23° W	38	
M								
N								
O				Chalk	26	S 41° E	37	
P				Chalk	18	S 43° W	32	
Q				Chalk	18	N 64° E	14	
R				" "	14	N 70° W	14	
S	Stone							

Probate files from courthouse and what formats we have them in:

- Original in Archives and LH Storage [in white banker boxes]
- 79 probate books
- Indexed on our Guardian/Probate Database:
<http://history.cdpl.lib.in.us/Presto/content/AdvancedSearch.aspx?ctlD=ZDA3MThlOTQtZjc1ZC00MGM4LTgzYjQtNTQ3MMDMwZDc1Mzgw>

Complete Probate records

Complete probate books housed in Archives

Have 81 volumes all indexed just main names not all who purchased etc -- 18,990 entries.



- Same books microfilmed in CDPL Local History Section.
- Index is on same database as probate files plus guardian docket that is blended together.

OLD Scanner

VS

NEW Scanner



To Left:
Overhead
scanner from
Nov 1999 to
2016.
\$16,000

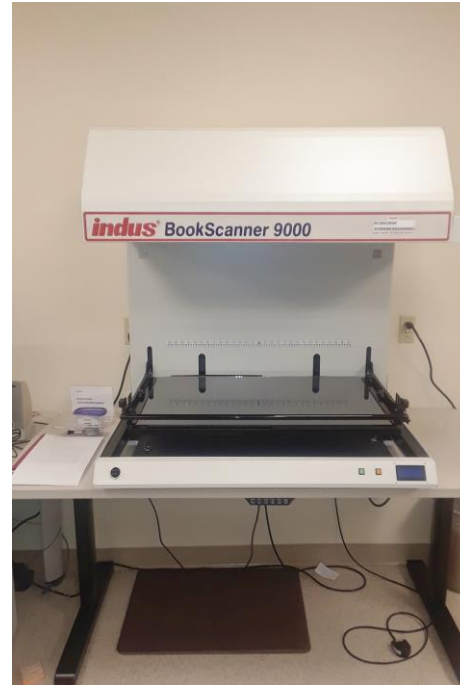

To Right:
New Scanner in
2019 funds from
an anonymous
donor. \$30,000

ARCHIVES AND DIGITIZING ROOM



Atlas of Cemeteries -- Veteran's Graves Registration Project (WPA 1940)



- **Brown Township** ([pdf](#))
- **Clark Township** ([pdf](#))
- **Coal Creek Township** ([pdf](#))
- **Franklin Township** ([pdf](#))
- **Madison Township** ([pdf](#))

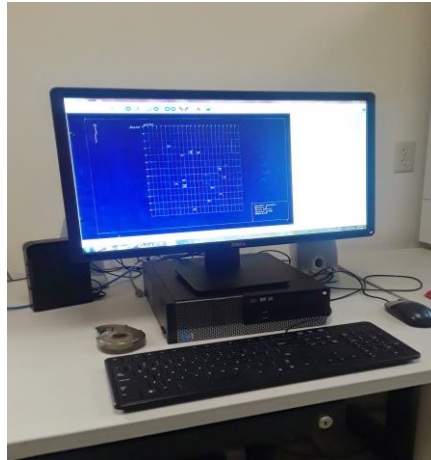

- **Ripley Township** ([pdf](#))
- **Scott Township** ([pdf](#))
- **Sugar Creek** ([pdf](#))
- **Union Township** ([pdf](#))
- **Walnut Township** ([pdf](#))
- **Wayne Township** ([pdf](#))

<http://www.cdpl.lib.in.us/services/local-history-and-genealogy>

INDEX of CEMETERIES by TOWNSHIP

MONTGOMERY COUNTY INDEX of CEMETERIES by TOWNSHIPS.											
No.	Cemetery	Location	Page	No.	Cemetery	Location	Page	No.	Cemetery	Location	Page
Browns											
1	Browns	Fort	4	40	Ermantrout	Fort	91	82	Benford	Fort	124
2	Freedom	Nw 1/4 12 17n 6w	5-7	50	Frasley	Se 1/4 12 20n 4w	92	83	Ben Hur	Nw 1/4 5 18n 4w	125
3	Harrell	Se 1/4 7 17n 5w	8	51	Linden	Sw 1/4 4 20n 4w	93-97	84	Beech	Sw 1/4 14 19n 5w	126
4	Jarvis	Nw 1/4 30 17n 5w	9	52	McDowell	Se 1/4 2 20n 4w	92	85	Benton	Nw 1/4 2 19n 5w	128
5	Lynch	Sw 1/4 20 17n 3w	18					86	Colvary	Nw 1/4 2 19n 4w	127-131
6	Maple Ridge	Sw 1/4 36 17n 6w	10-16					87	County Farm	Sw 1/4 20 19n 4w	132
7	Methodist	Se 1/4 36 17n 6w	17					88	Coons	Sw 1/4 23 18n 5w	132
8	Moore	Sw 1/4 30 17n 5w	18					89	Fairgrounds	Sw 1/4 32 19n 4w	133
9	Old Indian Creek	Nw 1/4 13 17n 5w	19	53	Alamo	Sw 1/4 24 18n 6w	98-100	90	Finley Chapel	Sw 1/4 22 18n 4w	137
10	Old Union	Se 1/4 24 17n 6w	20-22	54	Bunker Hill	Sw 1/4 19 18n 5w	101	91	Gale	Se 1/4 23 18n 5w	134
11	O'Wenner	Nw 1/4 0 17n 6w	5	55	McGormick	Sw 1/4 11 18n 6w	104	92	Green	Sw 1/4 26 19n 4w	135
12	Indian Creek Hill	Nw 1/4 19 17n 5w	23-25	56	O'Neil	Nw 1/4 30 18n 5w	102	93	Hampton	Sw 1/4 22 19n 4w	136
13	Resting	Nw 1/4 28 17n 5w	26	57	Jaacks	Sw 1/4 30 19n 5w	103	94	LOOF	Sw 1/4 6 18n 4w	137-140
14	Presbyterian	Nw 1/4 36 17n 6w	27-29	58	Texas	Nw 1/4 35 18n 6w	103	95	Horns	Nw 1/4 7 19n 4w	141
15	Rush	Nw 1/4 32 18n 5w	30	59	Yountsville	Sw 1/4 4 18n 5w	104	96	Lee	Sw 1/4 36 19n 4w	142
16	Sinnott	Nw 1/4 9 17n 5w	31	60	Willie	Sw 1/4 15 18n 6w	105	97	Liberty	Sw 1/4 3 20n 3w	143-145
17	Wasson	Nw 1/4 21 17n 5w	32					98	Lutheran	Se 1/4 20 18n 4w	146
Clark											
18	Clark	Nw 1/4 34 17n 3w	32					99	Masonic	Se 1/4 5 18n 4w	147-153
19	Bly	Nw 1/4 26 17n 3w	33	61	Armstrong	Nw 1/4 7 17n 4w	106	100	Michael	Nw 1/4 15 18n 5w	154
20	Ford	Nw 1/4 32 17n 3w	33	62	Ernst	Ne 1/4 12 17n 4w	107	101	Mr. Taylor	Nw 1/4 19 18n 4w	155
21	Harrison	Nw 1/4 28 17n 3w	34	63	Byce	Se 1/4 29 17n 4w	108	102	Mizell	Nw 1/4 35 19n 5w	156
22	Hornbarger	Nw 1/4 9 17n 3w	35-39	64	Cornstalk	Ne 1/4 34 17n 4w	109	103	Nutz	Se 1/4 10 18n 5w	157
23	Inlow	Nw 1/4 9 17n 3w	41-50	65	Fronts	Ne 1/4 34 17n 4w	110	104	Oak Hill	Sw 1/4 30 19n 4w	158-176
24	Lagoga	Nw 1/4 19 17n 3w	41-50	66	Vames	Se 1/4 31 17n 4w	111	105	Old town	Nw 1/4 31 19n 4w	177-179
25	Mt. Pleasant	Nw 1/4 18 17n 3w	34	67	McMurry	Nw 1/4 36 17n 4w	108	106	Oliver	Nw 1/4 23 18n 4w	181
26	Olson	Nw 1/4 25 17n 3w	32	68	Old Hornbarger	Nw 1/4 34 17n 4w	108	107	Shilah	Ne 1/4 3 18n 4w	181
27	Payley	Sw 1/4 11 17n 3w	52-54	69	Wein	Nw 1/4 32 17n 4w	112	108	Shaner	Sw 1/4 18 19n 4w	182
28	Shaner	Nw 1/4 21 17n 3w	52-54	70	Woolbaugh	Sw 1/4 12 17n 4w	113	109	Shelton	Sw 1/4 34 19n 4w	183
29	Wesley Chapel	Nw 1/4 35 17n 3w	55	71	Wasson	Sw 1/4 29 17n 4w	106	110	Stover	Ne 1/4 32 18n 4w	184
Coal Creek											
30	Coal Creek	Nw 1/4 15 20n 5w	56-57					111	Weir	Sw 1/4 21 18n 5w	185
31	McHenry	Se 1/4 2 20n 6w	58					112	White	Sw 1/4 20 18n 4w	184
32	Mouff	Nw 1/4 35 20n 6w	58					113	Wise	Nw 1/4 14 18n 4w	184
33	Mt. Pleasant	Se 1/4 23 20n 6w	5					114	Youngs Chapel	Sw 1/4 20 19n 4w	186-188
34	New Richmond	Nw 1/4 9 20n 5w	61-64					Walnut			
35	Oaklawn	Nw 1/4 29 20n 5w	65-67					115	Wagon	Se 1/4 17 18n 3w	189
36	Old Turkey Run	Nw 1/4 27 20n 6w	68					116	Wade	Se 1/4 15 18n 3w	190-194
37	Quince	Sw 1/4 2 20n 6w	69					117	Wagge	Nw 1/4 36 18n 3w	194
38	Reynolds Hill	Nw 1/4 22 20n 6w	70					118	Wash. Magee	Sw 1/4 7 18n 3w	196-202
39	White	Nw 1/4 30 20n 6w	59					119	W. Magee	Sw 1/4 15 18n 3w	204
Franklin											
40	Franklin	Nw 1/4 2 19n 3w	76					120	Old Magee	Nw 1/4 18 18n 3w	205-207
41	Emcoff	Se 1/4 11 18n 3w	71					121	Osage	Sw 1/4 13 18n 3w	208
42	Green Lawn	Nw 1/4 9 19n 3w	72-75					122	Osage	Nw 1/4 7 18n 3w	209
43	Hud	Sw 1/4 54 19n 3w	76					123	Providence	Se 1/4 12 18n 3w	210
44	LOOF	Nw 1/4 8 19n 3w	77-83					124	Spry	Nw 1/4 35 18n 3w	211
45	Old Union	Sw 1/4 26 19n 3w	84					125	Union Hill	Sw 1/4 16 18n 3w	210-211
46	Old Union	Sw 1/4 26 19n 3w	84					Wayne			
47	Shannonville	Nw 1/4 56 19n 3w	85-87					126	Wagon	Nw 1/4 2 19n 5w	212
48	St. James Lutheran	Nw 1/4 24 19n 3w	88-90					127	Hunter	Sw 1/4 25 19n 5w	213
								128	Massopio	Se 1/4 15 19n 6w	214-218
								129	Old Waynesown	Se 1/4 14 19n 6w	215
								130	Randy	Sw 1/4 3 19n 5w	220-222
								131	Switzer	Nw 1/4 29 19n 5w	216
								132	Thompson	Se 1/4 32 19n 5w	223
								133	Wesley	Nw 1/4 29 19n 5w	224-226

Coal Creek Farmers Association Ledger 1919-1924

<http://www.cdpl.lib.in.us/lh/township-misc/CoalCreekAlumniMinutes1955-1991.pdf>



This ledger was donated

by Rachel Brown to CDPL

Local History Collection out

Of her grandfather -----
collection.

60			61				
No	REC. NAME -	P.O.	AMT. \$	No	REC. NAME -	P.O.	AMT
1	EVANS - A.H.	WINGATE. R.R.#2.	4.00	26	WILSON - HARRY S.	WINGATE R.R.#2.	4.00
2	MEHARRY - JUDD F.	NEW RICHMOND - RR#2.	7.00	27	MURPHY - W.A.	WINGATE R.R.#2.	4.00
3	NEAL - R.R.	WINGATE -	4.00	28	LIVINGSTON - JOE -	NEW RICHMOND - #2	5.00
4	KIRKPATRICK - F.M.	WINGATE. R.R.#1.	4.00	29	ARMEFIELD - A.M.	NEW RICHMOND #2	4.00
5	GROSS - LAWRENCE -	WINGATE. R.R.#1.	4.00	30	DAZEY - A.W. -	NEW RICHMOND - RR#2.	5.00
6	McCULLOUGH - F.W.	WINGATE R.R.#1.	4.00	31	MITCHELL - R.A.	NEW RICHMOND - RR#1.	5.00
7	DAZEY - RAY C.	WINGATE R.R.#2	5.00	32	MITCHELL - E.O.	NEW RICHMOND - RR#1	5.00
8	HAMILTON - FAY -	NEW RICHMOND - R.R.#2.	5.00	33	MERITT - J.N.	NEW RICHMOND - RR#1	4.00
9	BRATTON JOHN -	NEW RICHMOND - RR#1.	4.00	34	MURDOCK - M.T.R.	WAYNETOWN -	5.00
10	ALLEN - LEE.	NEW RICHMOND - RR#2	5.00	35	KILLEN - A.G -	NEW RICHMOND - RR#2.	5.00
11	LONG - ROBERT -	NEW RICHMOND - RR#1.	4.00	36	GLOVER - ORRIN -	NEW RICHMOND - RR#2.	4.00
12	AUSTIN - JAKE -	NEW RICHMOND - RR#1.	4.00	37	JONES - W.T.	NEW RICHMOND -	4.00
13	BUNNELL - W.E. -	NEW RICHMOND - RR#1.	5.00	38	WHIPPLE - ^{ELGA} -	NEW RICHMOND - RR#2.	4.00
14	BUNNELL - THOMAS E.	NEW RICHMOND - RR#1.	5.00	39	FRIEBE - ^{DAVID} W.M.	NEW RICHMOND - R.R.#2.	5.00
15	FOUTS - CLAUDE J.	WINGATE - RR.#2.	5.00	40	KITE W.M.	NEW RICHMOND - RR.#2.	5.00
16	KIRKPATRICK QUINN -	NEW RICHMOND - RR#1.	5.00	41	KOCHELL FIRMAN -	NEW RICHMOND - RR#2.	5.00
17	BUNNELL - JACOB W.	NEW RICHMOND - RR#1	5.00	42	SWANK HARVEY -	NEW RICHMOND - RR#2	4.00
18	BUNNELL - OWELL	NEW RICHMOND - RR#1.	5.00	43	WESTFALL JOHN -	NEW RICHMOND - RR#2.	4.00
19	ALLEN - J.H.	NEW RICHMOND - RR#1.	5.00	44	SUTTON - DA D.	NEW RICHMOND - RR#2.	5.00
20	DOOLEY - L.L.	NEW RICHMOND - RR#1.	4.00	45	OPPY E.T.	NEW RICHMOND - RR#2	5.00
21	WALKER - ETTIE	NEW RICHMOND - R.R.#1.	5.00	46	OPPY - T.F.	NEW RICHMOND - RR#2.	5.00
22	BUNNELL - JAMES A.	NEW RICHMOND - RR#1.	4.00	47	GRAVES - C.W.	NEW RICHMOND - RR#2.	4.00
23	FOUTS - JAMES W.	NEW RICHMOND - RR#1	4.00	48	RICE RAYMOND -	NEW RICHMOND - R.R.#1.	4.00
24	COON - CLIFFORD -	WINGATE. R.R.#2	5.00	49	PATTON C.A.	NEW RICHMOND - R.R.#1.	4.00
25	MITCHELL N.K.	WINGATE R.R.#2.	5.00	50	WILSON - JAMES D.	NEW RICHMOND - RR#1 -	4.00

Plat map project

The CDPL Reference and Local History department has digitized and indexed the Montgomery County, Indiana **Assessor's Plat Map Books**.

Montgomery County has 11 Townships. Each averages 12 to 13 volumes.

[Some as early as 1875 and late as 1932.]

Brown, Clark, Coal Creek, Franklin, Madison, Ripley, Scott,

Sugar Creek, Union, Walnut, Wayne

Old Plat map locations

The plat maps original books are stored in **CDPL Archives** (temperature controlled area 66 degree 48 humidity]

Photocopies of originals in LH area on 2nd floor -- Brown, Clark, Coal Creek, Franklin, and Madison. Rest is waiting to go to bindery in near future. As you will see each volume is indexed

On our **CDPL** website here is link to all **145 plat books** index has **1583 entries**

<http://www.cdpl.lib.in.us/lh/township-plats/Montgomery-County-IN-Plat-Books-Index.pdf>

Plat maps (Before)



Plat Map being processing thru indexing after being photocopying at color printer



These bound copies will be more convenient for our patrons to view and make photocopies while protecting the old originals.

MONTGOMERY COUNTY, INDIANA, 190									
Ames's Plat-Book for		Section	Township, No.						
NAME OF OWNER	Acres	DESCRIPTION	1/4	1/2	3/4	Whole	Value	Assessed	Value of Land and Improvements
Davis Amanda	14	1/2 60'	14	11	5	30	4000	4000	
Davis Mary	14	1/2 60'	14	11	5	30	1800	1800	
Wickham John	14	1/2 60'	14	11	5	30	1100	1100	
Langue Mary	14	1/2 60'	14	11	5	30	200	200	
Wilcox R B	14	1/2 60'	14	11	5	30	200	200	
Davis J L Vane	14	1/2 60'	14	11	5	30	2000	2000	
Langue Joseph	14	1/2 60'	14	11	5	30	1100	1100	
Langue W A	14	1/2 60'	14	11	5	30	2100	2100	
Hallum Joseph	14	1/2 60'	14	11	5	30	1400	1400	

SECTION No.	
Congressional Township No. 17 R 5	
<p>SEAL: Party made to an inch, or ten rods to a section, Congress Land, when it was wide square for a section. Number of acres in this Section, according to the United States Survey.</p>	

